

## Electrical Characteristics

Module Type	ANSRMP1320240	ANSRMP1320245	ANSRMP1320250	ANSRMP1320255
Maximum Power-Pmax (W)	240	245	250	255
Maximum Power Voltage-Vmp (V)	27.9	28.1	28.3	28.5
Maximum Power Current-Imp (A)	8.60	8.72	8.83	9.01
Open Circuit Voltage-Voc (V)	34.0	34.2	34.4	34.6
Short Circuit Current-Isc (A)	9.05	9.18	9.32	9.46
Module Efficiency- $\eta_m$ (%)	18.2	18.5	18.9	19.3
Power Tolerance (W)	0/+5			
Maximum System Voltage ( $V_{DC}$ )	1000			
Maximum Series Fuse Rating (A)	15			
Operating Temperature ( $^{\circ}C$ )	-40~+85			
Pmax Temperature Coefficient ( $\%/^{\circ}C$ )	-0.40			
Voc Temperature Coefficient ( $\%/^{\circ}C$ )	-0.31			
Isc Temperature Coefficient ( $\%/^{\circ}C$ )	0.05			
Nominal Operating Cell Temperature ( $^{\circ}C$ )	44 $\pm$ 2			

STC: Irradiance 1000 W/m<sup>2</sup> module temperature 25 $^{\circ}C$  AM=1.5, Power measurement tolerance: +/-3%

## Mechanical Specifications

External Dimension	1623 $\times$ 814 $\times$ 35 mm
Weight	15.0Kg
Solar Cell	Mono 156.75 $\times$ 31.35 mm (260pcs)
Glass	3.2 mm tempered glass, low iron
Frame	Anodized aluminium alloy
Junction Box	IP68
Output Cable	4.0 mm <sup>2</sup> , cable length:900 mm
Connector	MC4 Compatible
Maximum Snow Load	5400 Pa or 550 Kg/mm <sup>2</sup>
Maximum Wind Load	2400 Pa or 244 Kg/mm <sup>2</sup>
Hail Resistance	Max. $\varnothing$ 28 mm, at 23 m/s

## Packing Configuration

Container	20'GP	40'HQ
Pieces per Pallet	30	30
Pallets per Container	6	28
Pieces per Container	180	840

## Linear Warranty

No more than 2.5% peak power degradation in 1<sup>st</sup> year;  
 No more than 0.7% peak power degradation in coming 24 years;  
 Free from defects of materials and workmanship for 12 years.

## Technical drawing

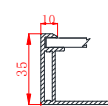
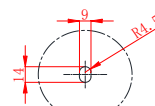
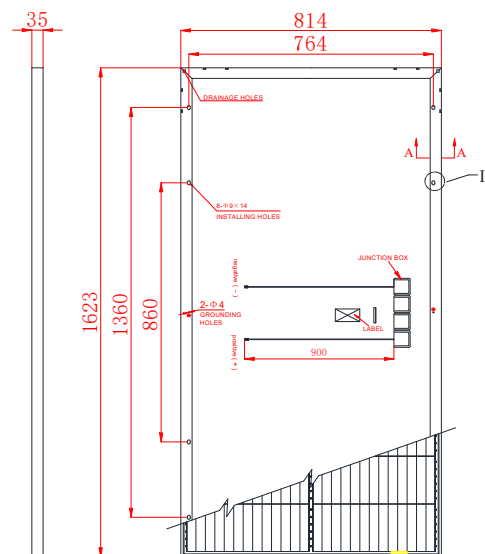

I

A-A

Unit:mm



Jiangyin EnergySaving Technology Co.,Ltd.  
[www.ansrsolar.com](http://www.ansrsolar.com) [info@ansrsolar.com](mailto:info@ansrsolar.com)